

INSTALLATION INSTRUCTIONS



Trusted in New Zealand Since 1982

BATHS



Englefield has a history of making superb baths and their popularity is testament to their quality and affordability.

It's the details that Englefield cares about - from pioneering the latest technology, to innovative design, it's all to make your bathing experience the very best it can be.

OPTIONAL UPSTAND

ROUGH IN DIMENSIONS

Product & Part Number	Rough-in dimensions
Valencia 1500 BTW FS BATH 1SD UPSTAND Sku number: 23738A-0	
Valencia 1700 BTW FS BATH 1SD UPSTAND Sku number: 23739A-0	
Sierra 1500 CNR BTW FS BATH 2SD LH UPSTAND Sku number: 23740A-0	
Sierra 1700 CNR BTW FS BATH 2SD LH UPSTAND Sku number: 23743A-0	
Sierra 1500 CNR BTW FS BATH 2SD RH UPSTAND Sku number: 23741A-0	
Sierra 1700 CNR BTW FS BATH 2SD RH UPSTAND Sku number: 23744A-0	
Sierra 1500 BTW FS BATH 3SD UPSTAND Sku number: 23742A-0	
Sierra 1700 BTW FS BATH 3SD UPSTAND Sku number: 23745A-0	

NOTE:

Check the rough-in and room dimensions to provide adequate space for the bath unit. Check the flooring under designated bath position and the wall to be attached and make repairs as needed. For best results, ensure that the floor is level and the wall is straight.

BEFORE YOU BEGIN

- 1). The upstand is an optional feature of the New Zealand products only.
- 2). Please carefully read these instructions together with the **Free Standing Back-to-Wall Bath Installation Instructions** to familiarise yourself with the required tools, materials and installation sequences.
- 3). The installation assumes that the mounting walls are plumb and the floors are level.
- 4). The installation shall only start after all necessary plumbing is completed.
- 5). All installations must comply with council and local authority by-laws.

INSTALLATION

- 1). Install the bath with upstand to the wall as shown in figure 1.
- 2). Install a packer (suggest 6-7mm thickness for 10mm wall board) between the wall frame and the upstand to ensure the front face of the upstand is flush with the surface of the wall board.
- 3). Apply silicone sealant as shown to form a watertight seal between the upstand and the wall board.
- 4). Apply a waterproof membrane to the walls, including onto the bath upstand. Finish the wall with tiles or another impervious surface.

INSTALLATION

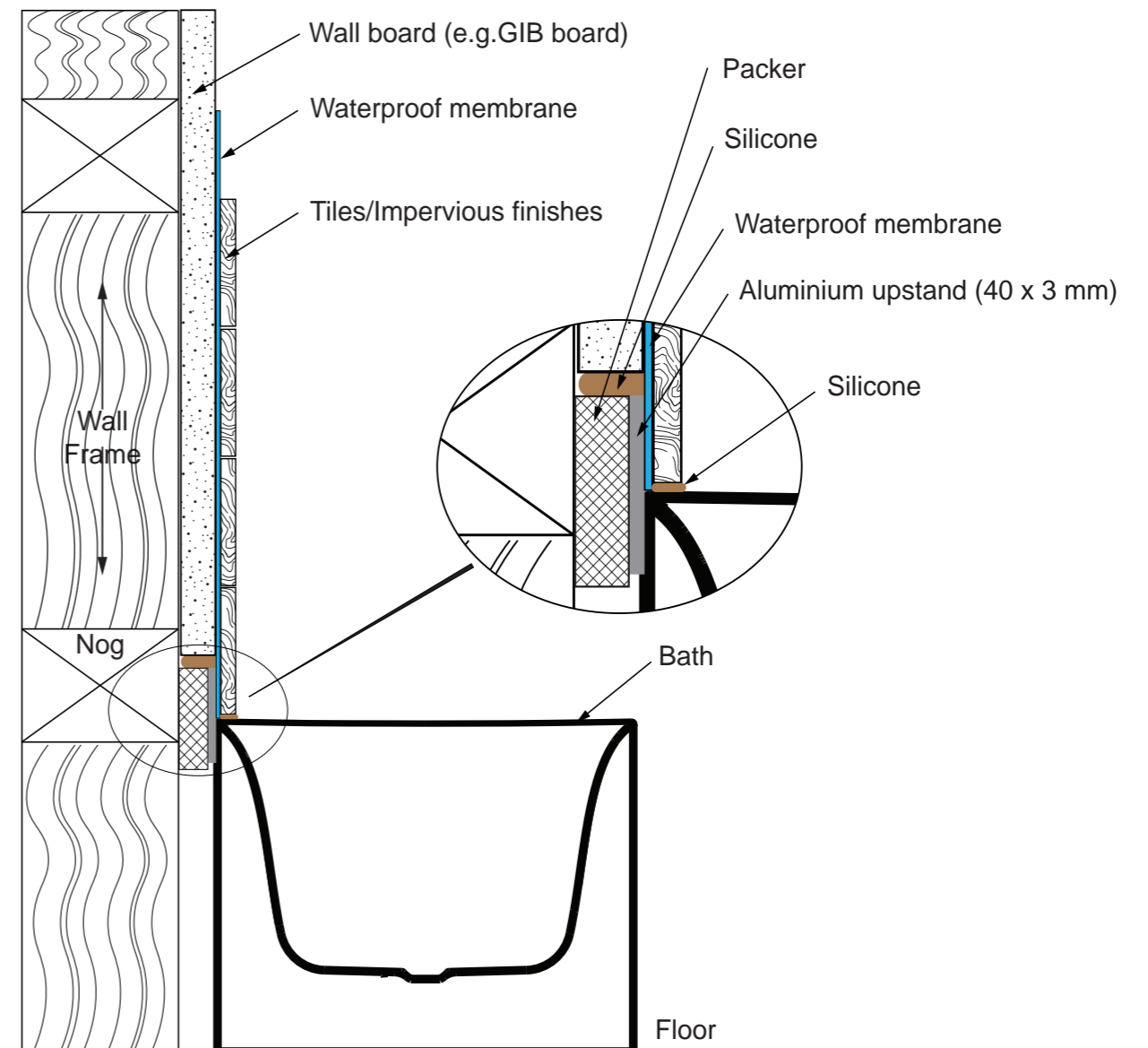

Figure 1

CONTACT AND WARRANTY INFORMATION

NEW ZEALAND
KOHLER NZ LTD

Free Ph: 0800 100 382
 Free Fax: 0800 664 488
www.inglefield.co.nz

AUSTRALIA
KOHLER AUSTRALIA

Free Ph: 1 800 ENGLEFIELD
 (1 800 364 533)
www.inglefield.com

For warranty information, please visit our website.



Trusted in New Zealand Since 1982